Elmhurst Cemetery

PERPETUAL GENERAL CARE

Perpetual general care includes mowing and reseeding grass; planting and care of flower beds, shrubs, and hedges; maintenance of buildings, fences, gates, and cemetery roads; and snow plowing. These services are provided at no extra cost to property owners. A Perpetual Care Fund, which grows with each new property sale, ensures that Elmhurst Cemetery will remain sacred and beautiful for generations.

Perpetual care does not include special services such as watering of individual lots or flowers, nor care or trimming around privately owned vases, markers, or monuments. These items are placed at the owner’s risk.

VISITOR RULES AND REGULATIONS

- Please be respectful of all visitors who may be mourning the loss of a loved one.
- Speed limit in the cemetery is 15 mph. Drive carefully and remain on paved roads.
- Any person found on the grounds after posted gate closing hours will be considered a trespasser.
- Place all trash in designated receptacles.
- Do not remove, pick, or disturb any plant, flower, shrub, or decoration that does not belong to you.
- All dogs must remain on a leash at all times.
- Joy riding or driver training in the cemetery is prohibited.
- Driving or parking on the grass is prohibited.
- Motorcycles and bicycles are prohibited except when attending a funeral or grave visitation.
- Loitering, loud talking, profanity, loud music, and the consumption of alcohol are prohibited.
- Digging holes for potted plants is prohibited.

Elmhurst Cemetery is not responsible for the loss or damage of any personal property placed on cemetery grounds, including but not limited to flowers, plants, decorations, vases, markers, or monuments. Each party, on behalf of itself and its related parties, agrees not to initiate or assist in any legal action or proceeding against the other party or its related parties concerning any released claims, in any jurisdiction.

SCATTERING OF CREMATED REMAINS

The scattering of cremated remains is not permitted on the grounds of Elmhurst Cemetery.

FOOD RESTRICTIONS

Elmhurst Cemetery understands that food offerings are an important part of cemetery rituals for many families. To prevent litter, pests, and maintenance issues, food left at gravesites is discouraged but not prohibited. Any food or drink left at gravesites will be removed by cemetery staff in a timely manner.

DECORATION POLICY

Elmhurst Cemetery recognizes that decorations are a meaningful expression of remembrance. To maintain beauty, consistency, and safety on the grounds, please follow the policies below. Items not in compliance may be removed by cemetery staff.

Marker Lots:

- Artificial flowers are permitted only between November 1 – March 31.
- Fresh cut flowers are allowed from April 1 – October 31 and in approved containers only. Complimentary green flower cones are available near the office. Limit two per grave. Coffee cans, glass jars, or other breakable containers are not permitted and will be removed.
- Annuals may be planted April 1 – September 30 in a flowerbed on the grave side of the marker. The bed must not exceed the width of the marker. Heavy duty black rubber landscape edging may be used as a flower border. If a flower bed must be removed for an interment, the cemetery is not responsible for replacement.
- Potted plants or flowers may be set in front of the stone; limit one per grave. Please remove your pots after the growing season for safe keeping. Cemetery staff will remove any remaining plants and flowers during our annual fall clean-up.

Maintenance around the marker grave is the sole responsibility of the property owner.

Monument Lots:

- Fresh cut and artificial flowers are permitted year-round in vases attached to the monument.
- Annuals may be planted April 1 – September 30 in a flowerbed on the grave side of the monument, within the property line. If both sides of a monument are owned by the same person, flowerbeds may be planted on both sides of the monument. Heavy duty black rubber landscape edging may be used as a flower border. If a flower bed must be removed for an interment, the cemetery is not responsible for replacement.
- Potted plants or flowers may be set in front of the stone; limit one per grave. Please remove your pots after the growing season for safe keeping. Cemetery staff will remove any remaining plants and flowers during our annual fall clean-up.

Maintenance around the monument grave is the sole responsibility of the property owner.

Niches

- *Niche vases are not allowed on the niche fronts in the Garden of Grace.*
- Niche owners in the Cremation Garden may purchase a niche vase for fresh or artificial flowers only.
- Tape, glue, stickers, or other substances used to attach items to niche fronts are prohibited and will be removed.
- Balloons tied to a niche vase are not permitted.

Spring & Summer Holidays

Spring and summer holidays include Easter, Memorial Day, Mother’s Day, and Father’s Day.

Flags, pinwheels, smaller potted plants, and artificial flowers are permitted one week before the holiday and will be removed the week following the holiday.

Wreaths

- Property owners may place real or artificial wreaths on graves between November 1 – March 1.
- Wreaths must be removed prior to spring clean-up, typically after March 1, if the owner wishes to retain them.
- Christmas wreaths purchased through the cemetery office will be placed by our staff the week of Thanksgiving and remain on graves typically through February.

PROHIBITED Decorations

The following items are NOT permitted in Elmhurst Cemetery and will be removed. This list is not exhaustive.

- Trees, bushes, shrubs, rosebushes, or perennials such as hostas, day lilies, peonies, etc.
- Decorative rocks, stones, bricks, fences, crosses, metal stands, holders, hooks, wood, iron, statuary or wire work, trellises, etc.
- Plaques
- Balloons
- Grave blankets
- Shepherd’s hooks
- Glass jars and other breakable vases / decorations
- Solar lights
- Ceramic figurines
- Wind chimes
- Photographs
- Bird houses
- Garden or stepping stones
- Pinwheels (except during major holidays)
- Trinkets and other non-floral objects

Removed Items

Elmhurst Cemetery reserves the right to remove all decorations or plants that do not conform to these rules or that become unsightly, overgrown, diseased, or hazardous. Elmhurst Cemetery is not liable for the removal or damage of decorations.

Removed items may have been placed in the cabinet next to the maintenance shed. You are welcome to search the cabinet for your decoration. The cabinet is cleaned out bi-annually, prior to spring and fall cleanups.

CEMETERY OFFICE HOURS

Monday – Friday
9:00 A.M. to 4:00 P.M.
Closed Saturday and Sunday

GATE HOURS

Oct. through March 7:00 A.M. to Dusk
April through Sept. 7:00 A.M. to 8:00 P.M.

Elmhurst Cemetery

ESTABLISHED 1858

OWNED BY

ST. JOHN LUTHERAN

AND

CROWN OF LIFE LUTHERAN CHURCH

1510 North Dale Street
St. Paul, MN 55117

Cemetery Office
(651) 489-1707

ELMHURST CEMETERY

1510 Dale Street North
Saint Paul, MN - 55117

Phone: 651-489-1707
www.elmhurstcemetery.org

*Elmhurst
Cemetery*

HOW TO LOCATE A LOVED ONE

Instructions on how to use our website to locate your loved ones:
• elmhurstcemetery.org
• Tap on "locate a loved one"
• Type in the last name
• Clicking on a name will take you to the map
Have Questions? Give us a call.
(651) 489-1707

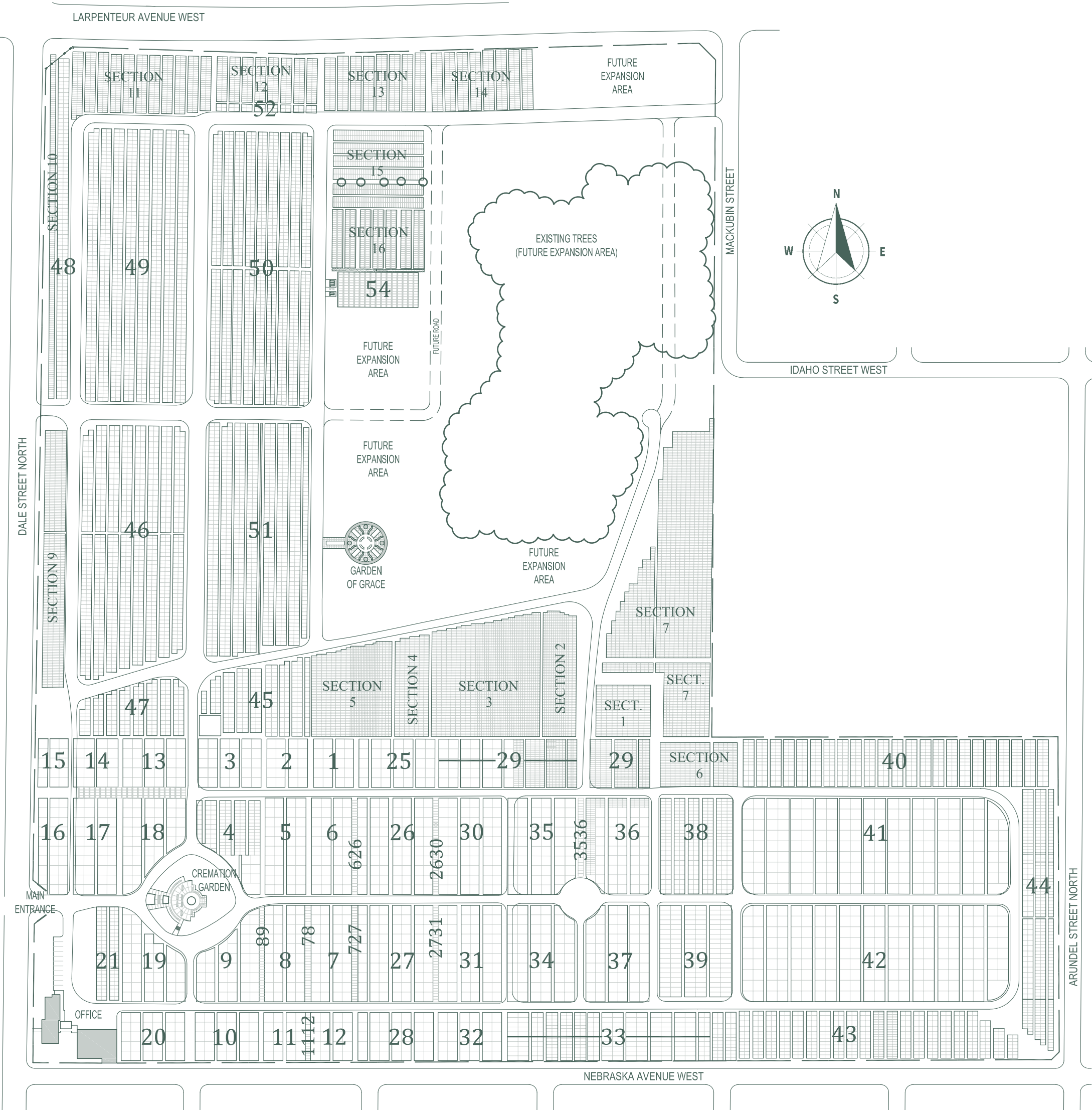

MAP UPDATED by IOA, Inc. - 09/05/2025

